

karnak

A PASSAGE TO ELEGANCE

A post-modern design.
Minimalism and aesthetics
could only be combined
as successfully as they are
in Karnak.



technical specs page 98



karnak

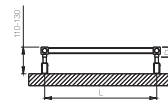
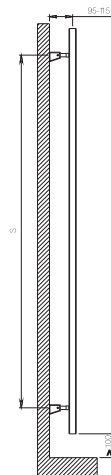
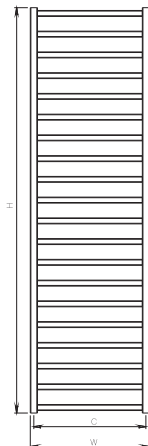
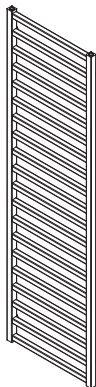

material	finish	electric version	wall installation	warranty
steel	RAL painted chrome plated	300 W 600 W	vertical	5 years

max. working pressure: 10 bar
max. working temperature: 95°C
all dimensions are in mm.
connections 1/2"

Product Code	Width	Height	Depth	Connection Centers	Tube Quantity	Assembly Axis		Weight	Water Capacity	THERMAL POWER (Painted)			THERMAL POWER (Chrome Plated)		
	W	H	D	C		S	L	kg.	lt.	btu	k/cal	watt	btu	k/cal	watt
KAR0500100012	500	1000	50	470	12	783	470	7,3	4,4	1445	364	423	1086	273	318
KAR0500170020	500	1700	50	470	20	1479	470	12,1	7,3	2424	611	710	1820	458	533

Vermogen (Watt) berekend op 75/65/20 graden Delta T50
Bij 90/70/20 graden vermenigvuldig het vermogen met 1.26

KARNAK



carisa
design radiator

The contents of this document are property of Termosan® and should not be copied, reproduced or disclosed to a third party without written consent of the proprietor.

www.carisa.com.tr

www.termosan.com
info@termosan.com

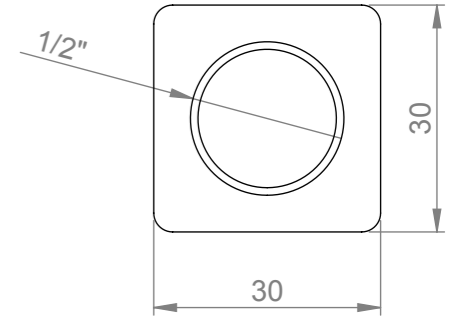
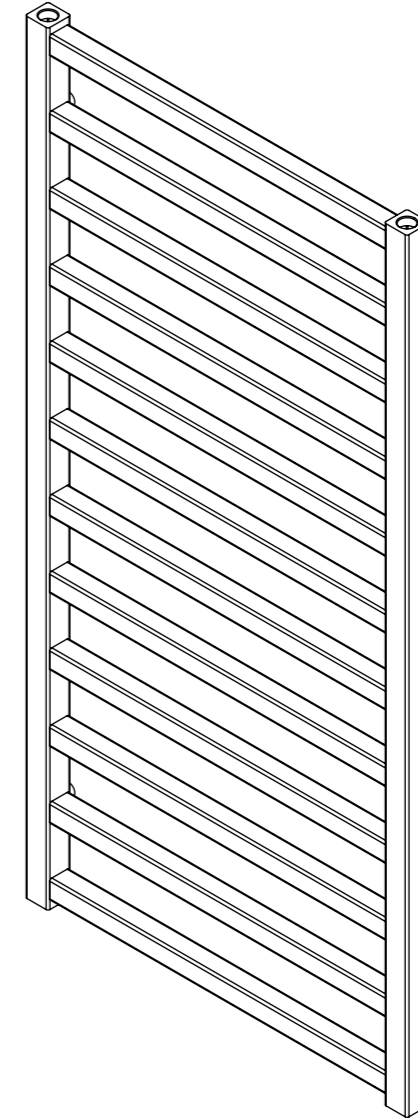
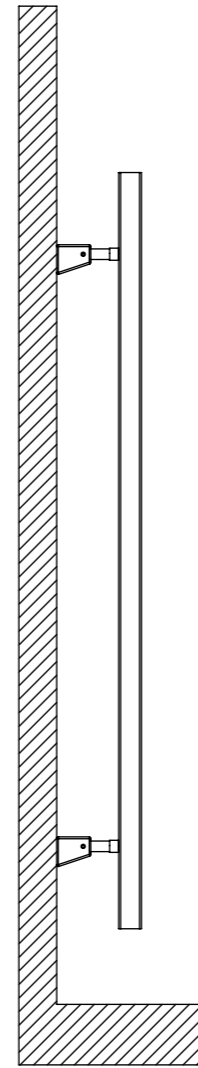
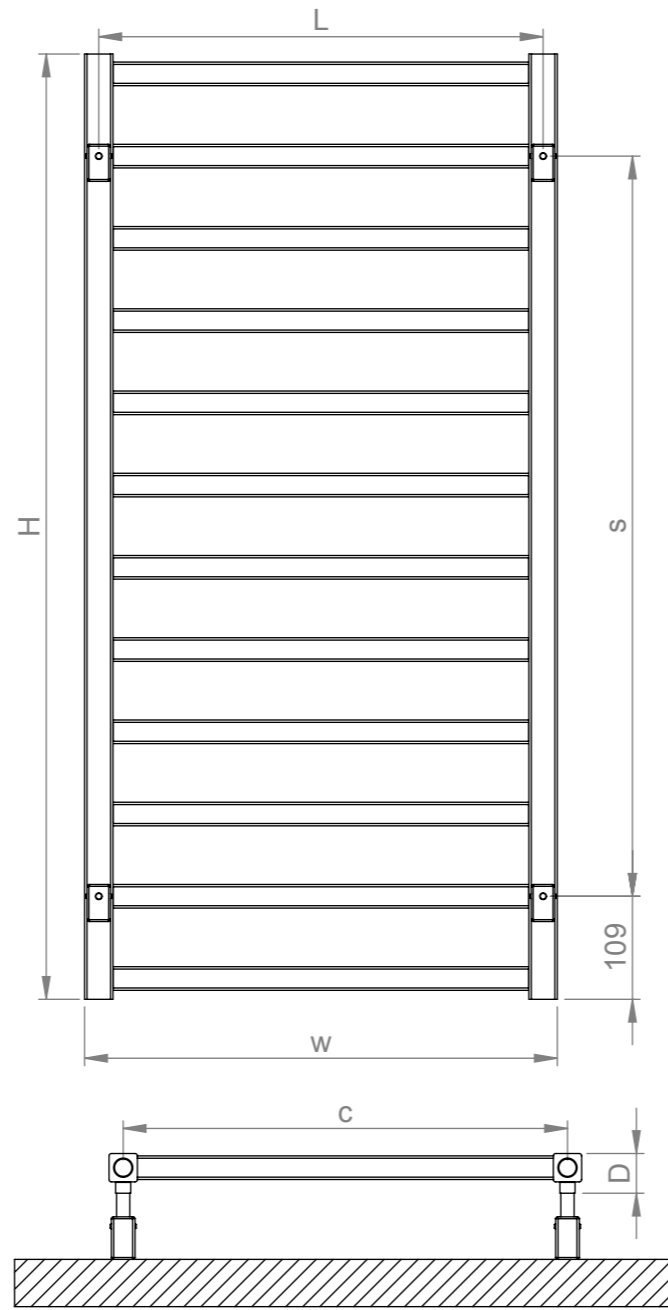
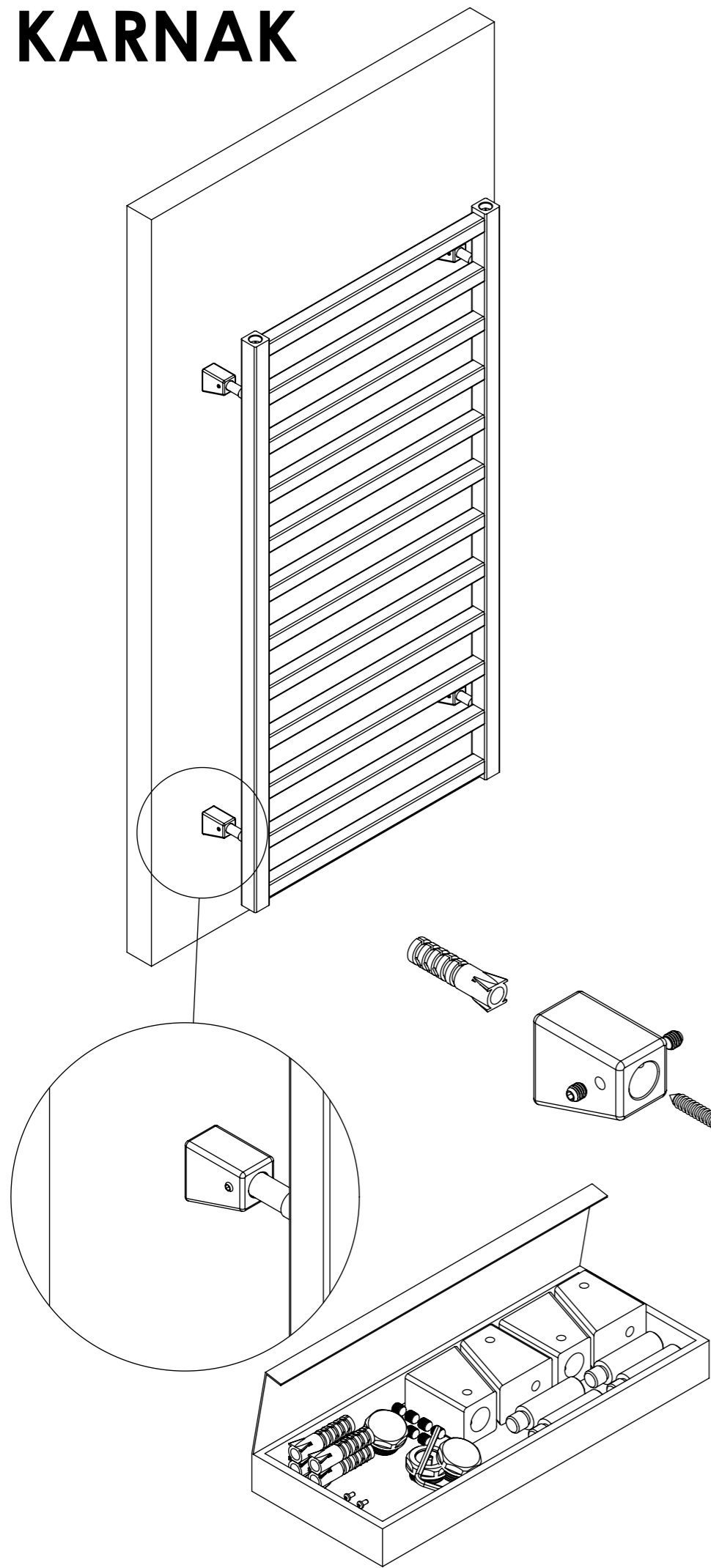

Product Code	Width	Height	Depth	Connection Centers	Tube Quantity	Assembly Axis		Weight	Water Capacity
	W	H	D	C		S	L	kg.	lt.
KAR0500100012	500	1000	50	470	12	783	470	7,3	4,4
KAR0500170020	500	1700	50	470	20	1479	470	12,1	7,3