

WIND OF HEAT

This radiator is a good reason for preferring the stylish appearance of stainless steel. Notus will underline the charm of austerity in your room.

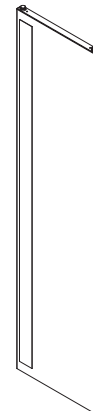

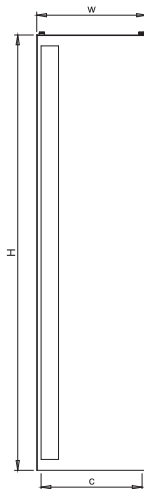
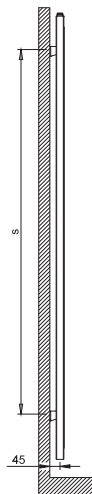
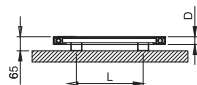

notus

| material | finish | electric version | wall installation | warranty |
|-----------------|----------------|------------------|-------------------|----------|
| stainless steel | satin polished | 900 W | vertical | 5 years |
| steel | | 1200 W | | |

max. working pressure: 10 bar
 max. working temperature: 95°C
 all dimensions are in mm.
 connections 1/2"

| Product Code | Width | Height | Depth | Connection Centers | Tube Quantity | Assembly Axis | | Weight | Water Capacity | THERMAL POWER | | |
|-----------------|-------|--------|-------|--------------------|---------------|---------------|-----|--------|----------------|---------------|-------|------|
| | W | H | D | C | | S | L | kg. | lt. | btu | k/cal | watt |
| NOT040018000009 | 400 | 1800 | 35 | 360 | - | 1470 | 200 | 26,4 | 8,2 | 2879 | 725 | 843 |
| NOT040020000009 | 400 | 2000 | 35 | 360 | - | 1645 | 200 | 29,2 | 9,2 | 3227 | 813 | 945 |
| NOT050018000009 | 500 | 1800 | 35 | 460 | - | 1470 | 300 | 31,1 | 9,8 | 3508 | 884 | 1028 |
| NOT050020000009 | 500 | 2000 | 35 | 460 | - | 1645 | 300 | 34,4 | 10,9 | 3934 | 991 | 1153 |
| NOT060018000009 | 600 | 1800 | 35 | 560 | - | 1470 | 400 | 35,9 | 11,3 | 4136 | 1042 | 1212 |
| NOT060020000009 | 600 | 2000 | 35 | 560 | - | 1645 | 400 | 39,7 | 12,7 | 4641 | 1169 | 1360 |

Vermogen (Watt) berekend op 75/65/20 graden Delta T50
 Bij 90/70/20 graden vermenigvuldig het vermogen met 1.26

NOTUS

The contents of this document are property of **Termosan®** and should not be copied, reproduced or disclosed to a third party without written consent of the proprietor.

www.carisa.com.tr

www.termosan.com
info@termosan.com

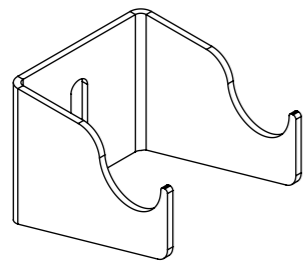
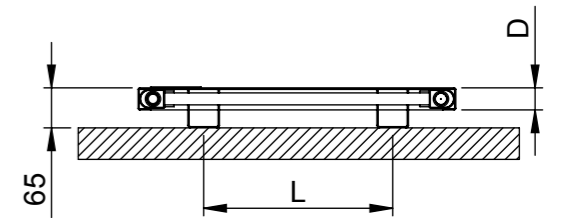
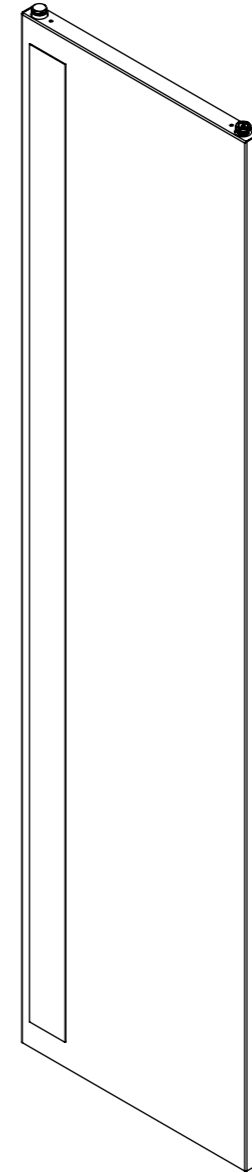
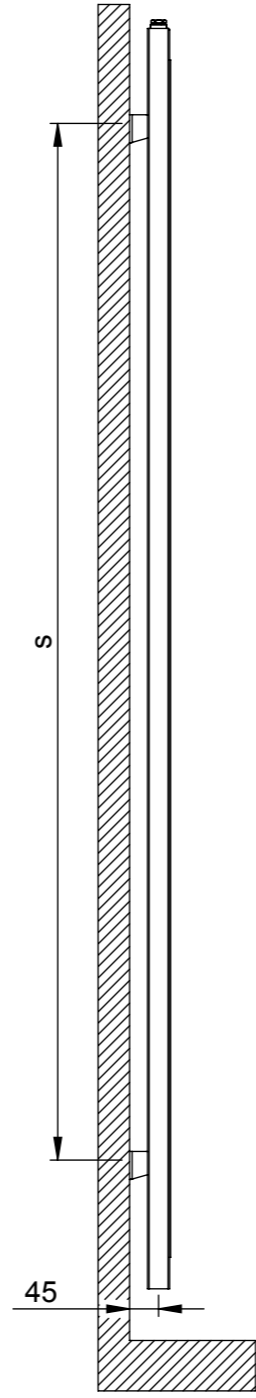
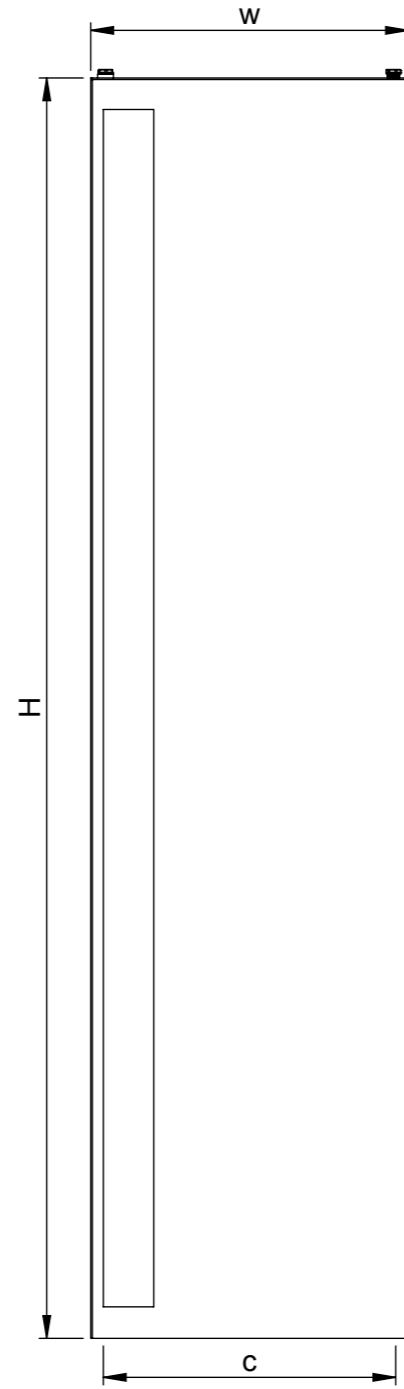
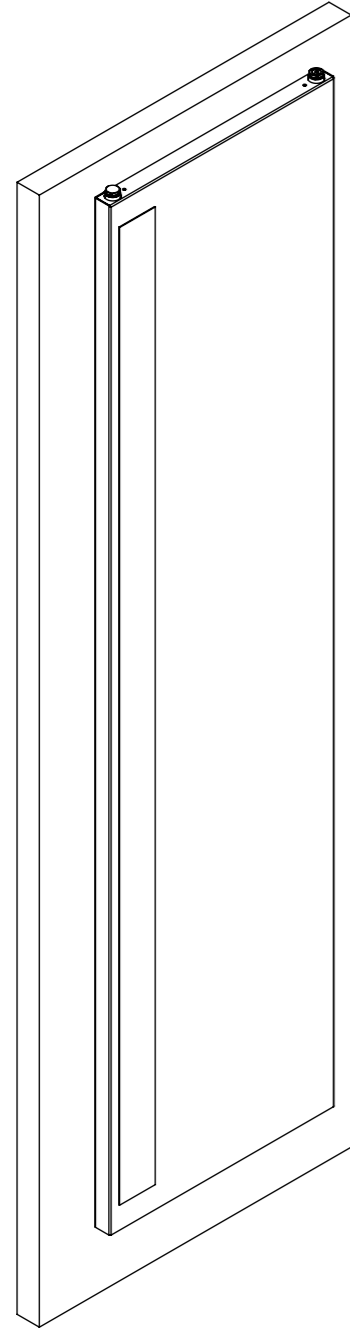

x4 Pcs.

| Product Code | Width | Height | Depth | Connection Centers | Tube Quantity | Assembly Axis | | Weight | Water Capacity |
|-----------------|-------|--------|-------|--------------------|---------------|---------------|-----|--------|----------------|
| | W | H | D | C | | S | L | kg. | lt. |
| NOT040018000009 | 400 | 1800 | 35 | 360 | - | 1470 | 200 | 26 | 8 |
| NOT040020000009 | 400 | 2000 | 35 | 360 | - | 1645 | 200 | 29 | 9 |
| NOT050018000009 | 500 | 1800 | 35 | 460 | - | 1470 | 200 | 31 | 10 |
| NOT050020000009 | 500 | 2000 | 35 | 460 | - | 1645 | 200 | 34 | 11 |
| NOT060018000009 | 600 | 1800 | 35 | 560 | - | 1470 | 200 | 36 | 11 |
| NOT060020000009 | 600 | 2000 | 35 | 560 | - | 1645 | 200 | 40 | 13 |